

## The Best Practice Solution for Continuous Insulation – GreenGirt™ 1.5"

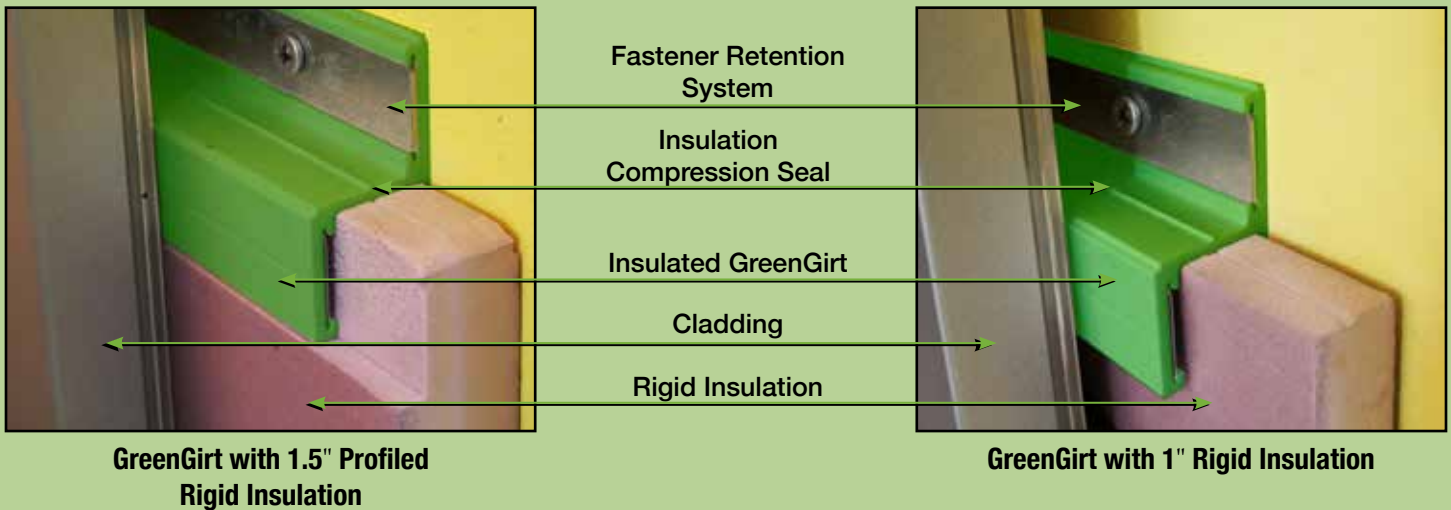

**SMARTci GreenGirt 1.5"** is an innovative, complete solution for continuous insulation designed for both 1" and 1.5" rigid board, mineral wool, and spray foam insulations.

Engineered as a continuous insulation system, SMARTci includes composite girt/attachment members (called GreenGirt), insulation, an engineered installation package, and optional accessories.

GreenGirt joins the building cladding and insulation to a building structure. It's an insulated composite sub-framing component inside the SMARTci assembly.

**ENVIRONMENTALLY FRIENDLY:** SMARTci is a recyclable building life product that will help in LEED certification. It creates significant energy savings and reduced carbon emissions. GreenGirt uses naturally sourced bioresin and recycled glass materials.

**UTILIZING PROVEN TECHNOLOGY:** SMARTci has been designed via element analysis, fully tested with ASTM and UL agencies and proven in the field. All components and materials in the SMARTci system have been vigorously tested and proven in the construction industry.

**GreenGirt IS BETTER THAN STEEL:** It is superior to steel structurally and thermally. GreenGirt is designed to provide the same loading capabilities of a Z girt of equivalent depth. Regular metal girts and through-fasteners create thermal bridging in the insulation system, but GreenGirt eliminates these. Furthermore, GreenGirt is not susceptible to moisture, corrosion or electrochemical reactions.

**NO THERMAL BRIDGING:** SMARTci is designed to provide an insulation system free of metal-thermal bridging. By utilizing insulated composite sub framing GreenGirts, the thermal "short circuit" is simply eliminated.

- ⌘ Effective R-values with 1" rigid board or 1.5" routed and profiled rigid board, mineral wool, and spray foam insulations
- ⌘ Easy, efficient and simple installation, no blind fastening or through put fasteners
- ⌘ R-value and thermal performance for warm climates
- ⌘ Universal with all cladding, substrate or insulation
- ⌘ Code compliant for all for 1.5" continuous insulation
- ⌘ Same proven superior wall efficiency of as with other GreenGirt sizes
- ⌘ Easy field fabrication
- ⌘ Horizontal or vertical installation
- ⌘ R-value ratings  
Mineral Wool 1.5" = R-6.45  
Polyiso 1.5" = R-10  
Polyiso 1" = R-6.5

## What's the Big Deal

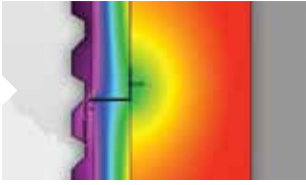

**Conventional System:**  
Fasteners and framing contribute to energy loss

### The Problem: Thermal Bridging

When metal is used to connect the exterior components of a building directly to the interior framing, this causes a thermal bridge. This thermal path of least resistance allows heat (or cold) to escape, creating a vulnerability or cold spots and allowing moisture problems. Using materials that eliminate the thermal bridge help avoid unnecessary heating and cooling costs.

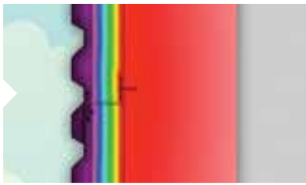

**SMARTci System:**  
Minimizing the thermal impact of fasteners and framing

### The Solution: SMARTci

SMARTci was designed to address the inadequacies of other continuous insulation solutions. It's individual parts were created as a simple, complete solution to help you create smarter buildings. Plus, it's the best assembly to help you earn points toward LEED certification. Unlike other attachment systems, SMARTci completely prevents thermal bridging that is created by metal fasteners and framing. It doesn't create cold spots for condensation inside your walls. It has a universal attachment design for virtually any cladding and it can be used over multiple surfaces — not just stud walls.

\* U.S. and Global Patents Pending



### SMARTci GreenGirt™ 1.5" best practices using:

- Materials proven and project tested for decades
- Details proven and project tested for decades
- Designed for easy installation
- Third-party tested and validated
- Superior performance products
- Products and details that provide installation efficiency
- Products that present an excellent value proposition



SMARTER BY DESIGN. PROVEN BY PERFORMANCE.

[www.smartcisystems.com](http://www.smartcisystems.com) | 269.355.1818

Advanced Architectural Products  
SMARTci Systems

959 Industrial Drive  
Allegan, MI 49010 | 269.355.1818



See the differences here at our web site: [www.smartcisystems.com](http://www.smartcisystems.com)

Patent Pending